

KŌ'ŪLA

Tower Floor Plate

Designed by
Studio Gang Architects
Yabu Pushelberg

Tower Floor Plate

MOUNTAINS

- Studios
- 1 Bedrooms
- 2 Bedrooms
- 3 Bedrooms

SUNSET

DIAMOND HEAD

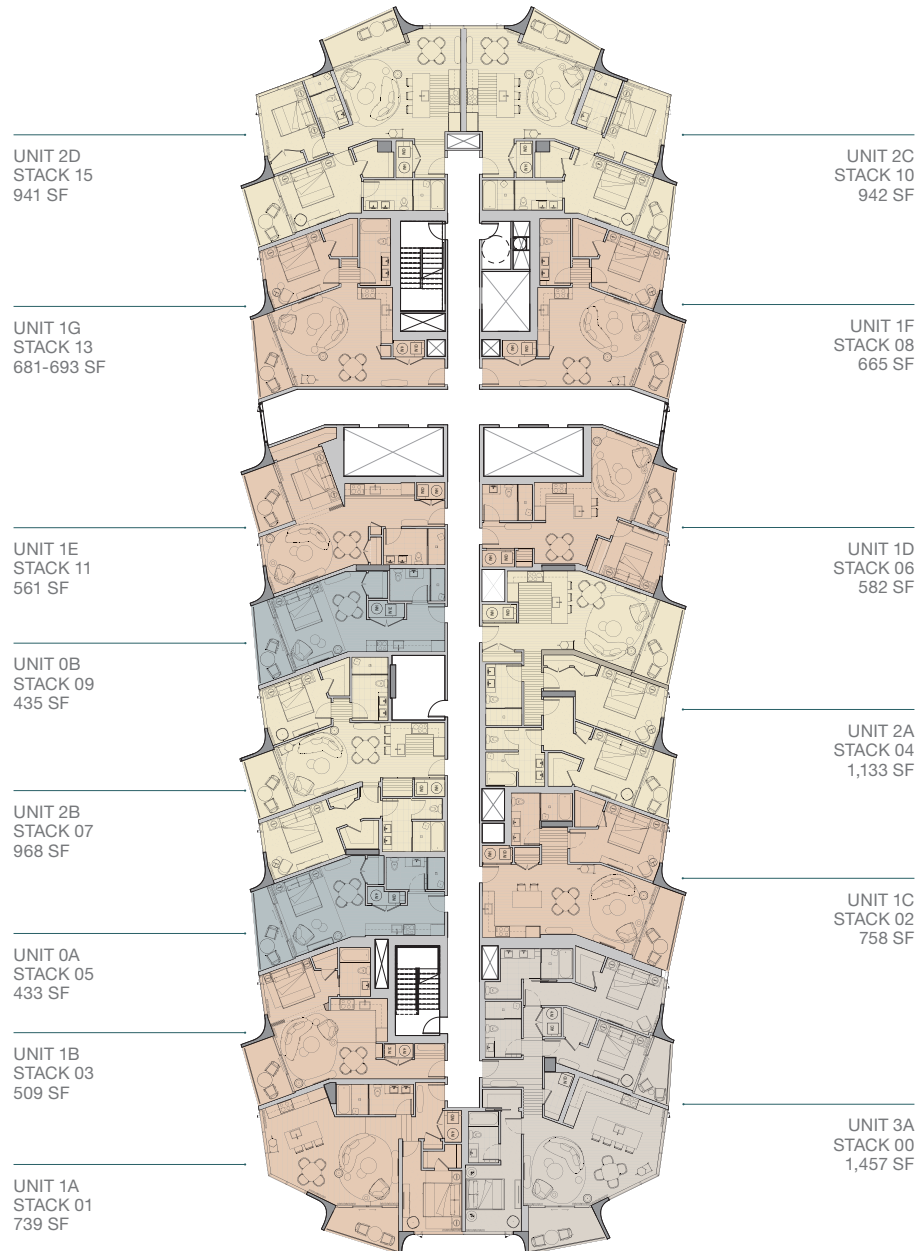

INTERIOR SQUARE FOOT MEASUREMENT SHOWN

OCEAN



KŌ'ŪLA IS A PROPOSED CONDOMINIUM PROJECT (THE "PROJECT") TO BE LOCATED IN HONOLULU, HAWAII THAT DOES NOT YET EXIST. AS SUCH, AN EFFECTIVE DATE FOR THE DEVELOPER'S PUBLIC REPORT ("PUBLIC REPORT") COVERING THE PROJECT HAS NOT YET BEEN ISSUED BY THE STATE OF HAWAII REAL ESTATE COMMISSION (THE "REC"). ACCORDINGLY, THE DEVELOPER OF THE PROJECT ("DEVELOPER") MAY NOT ENTER INTO BINDING SALES CONTRACTS WITH PROSPECTIVE PURCHASERS, COLLECT ANY MONEYS FROM PROSPECTIVE PURCHASERS OR ANYONE ON BEHALF OF PROSPECTIVE PURCHASERS, OR REQUIRE OR REQUEST THAT PROSPECTIVE PURCHASERS EXECUTE ANY DOCUMENT (OTHER THAN A NONBINDING PREREGISTRATION AGREEMENT, IF OFFERED BY THE DEVELOPER IN ITS DISCRETION), ONLY AFTER THE REC HAS ISSUED AN EFFECTIVE DATE FOR THE PUBLIC REPORT FOR THE PROJECT, SAID PUBLIC REPORT HAS BEEN DELIVERED TO PROSPECTIVE PURCHASERS, AND THE OTHER REQUIREMENTS OF HAWAII REVISED STATUTES § 514B-86 HAVE BEEN MET, MAY THE DEVELOPER ENTER INTO BINDING SALES CONTRACTS WITH PROSPECTIVE PURCHASERS. WARD VILLAGE IS A PROPOSED MASTER PLANNED DEVELOPMENT IN HONOLULU, HAWAII THAT IS CURRENTLY BEING DEVELOPED, BUT IS NOT YET COMPLETE. VISUAL DEPICTIONS OF WARD VILLAGE ARE FOR ILLUSTRATIVE PURPOSES ONLY AND DO NOT REPRESENT ACTUAL AMENITIES OR FACILITIES IN WARD VILLAGE AND SHOULD NOT BE RELIED UPON IN DECIDING TO PURCHASE OR LEASE AN INTEREST IN THE PROJECT. FURTHER, ANY RENDERINGS, PHOTOS, DRAWINGS OR OTHER REPRESENTATIONS AS TO UNITS OR OTHER ELEMENTS OF THE PROJECT THAT ARE DELIVERED OR SHOWN TO PROSPECTIVE PURCHASERS MAY NOT ACCURATELY PORTRAY SUCH UNITS AND OTHER ELEMENTS, AND DO NOT CONSTITUTE A REPRESENTATION BY THE DEVELOPER. THE DEVELOPER MAKES NO GUARANTEE, REPRESENTATION OR WARRANTY WHATSOEVER THAT THE DEVELOPMENTS, FACILITIES OR IMPROVEMENTS DEPICTED WILL ULTIMATELY APPEAR AS SHOWN. THIS IS NOT INTENDED TO BE AN OFFERING OR SOLICITATION OF SALE. EXCLUSIVE PROJECT BROKER WARD VILLAGE PROPERTIES, LLC (RB-21701) COURTESY TO QUALIFYING BROKERS; SEE PROJECT BROKER FOR DETAILS. COPYRIGHT ©2018. EQUAL HOUSING OPPORTUNITY.



WARD VILLAGE

Howard Hughes